

**MEET
PLAY**



***OPPORTUNITY
MEETS HERE***

PULLMAN MELBOURNE ON THE PARK





MEET, CONNECT AND SOCIALISE

Pullman Melbourne on the Park is one of the top meeting and conference destinations in Melbourne. Collaborative, connected, flexible and focused, we are the perfect tech-savvy host for your event.

Placed at the threshold of Melbourne's business, cultural, sporting and dining precincts, our rooms and facilities overlook the Fitzroy Gardens and the iconic Melbourne Cricket Ground (MCG). The vibrant business and social heart of the city is only minutes away on foot or public transport.

Conferences thrive here, supported by our five star facilities and our accomplished events team. Eleven stylish meeting rooms have in-built, high-quality audio visual equipment and a specialist onsite AV partner, Audio Visual Dynamics.

Post-conference social networking can include a group pilgrimage to the MCG, a Yarra River cruise or a tour of Melbourne's distinctive street art scene.

Why separate business and pleasure? We never do at Pullman Melbourne on the Park.

GRAND BALLROOM

The Grand Ballroom boasts 4.8 metre high ceilings and over 700sqm of flexible conference and event space. Versatile and elegant, the Grand Ballroom can accommodate up to 1000 guests and can be split into three individual event spaces with a large, light-filled pre-function areas. Features include:

- Multiple function room combinations
- High definition digital projectors and in-built motorised wide screens
- Fully integrated audio systems
- LED colour lights
- Wireless enabled internet
- Space for 25 exhibition booths

GOVERNORS' WING

The Stradbroke, Huntingfield and Delacombe Room offer magnificent views of the MCG and Fitzroy Gardens. With 3 metre high ceilings, the versatile 277sqm space can be split into three individual rooms. Seating up to 240 guests, this room is the perfect option for large plenary sessions that break out into concurrent meetings. Features include:

- Large windows with plenty of natural light (block out blinds if required)
- Multiple function room combinations
- Digital projectors and in-built motorised wide format screens
- Fully integrated audio systems
- Wireless enabled internet

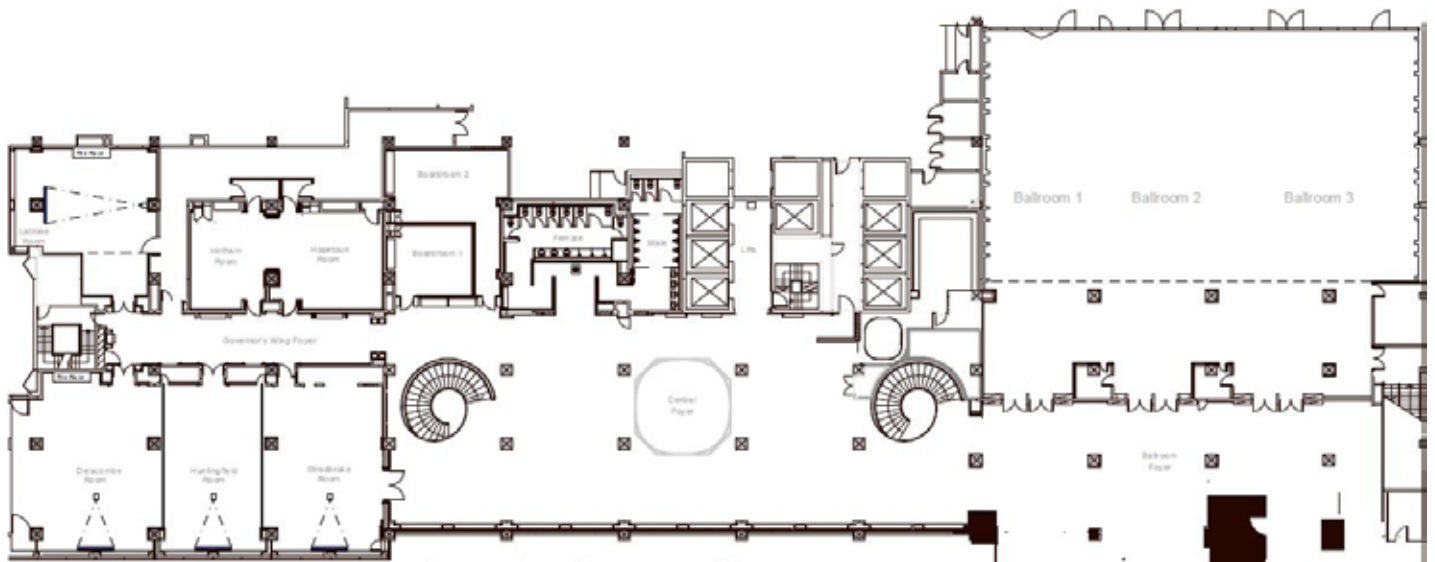

ELEGANT & COMFORTABLE ROOMS

Pullman guest room facilities:

- 28 sqm vibrant and contemporary rooms
- 40 Superior Suites with separate lounge and bedroom
- Smart TV
- Wi-Fi internet
- Deluxe mini bar
- Co Bigelow bathroom amenities and in-room safe
- Daily housekeeping and valet laundry services
- Large opening windows showcasing grand views of the city, MCG or Fitzroy Gardens

GUEST SERVICES AT THE HOTEL

- 24 hour Connectivity Lounge
- 24 hour undercover car park & valet parking
- Laundry service
- 24 hour room service
- Restaurant and bar
- Wi-Fi internet access
- Express check-in/check-out
- Concierge
- Foreign currency exchange
- Executive Lounge
- Heated outdoor pool, spa, sauna and fitness centre

MEETING ROOMS	AREA(M ²)	L	W	U-SHAPE (SINGLE)	CLASSROOM	BOARDROOM	THEATRE	BANQUET DINNER	COCKTAIL
Ballroom 1	188	24.8	7.6	42	90	54	234	120	150
Ballroom 2	193	24.8	7.6	42	90	54	234	120	150
Ballroom 3	322	24.8	13	54	158	54	338	200	300
Ballroom Foyer	245	24.8	13					24	300
Stradbroke Room	490	11	8.3	30	45	24	80	60	60
Huntingfield Room	70	11	6.3	30	45	24	80	60	60
Delacombe Room	115	11	10.4	30	45	24	100	80	80
Hopetoun Room	55	7.1	7.8	18	18	12	40	30	30
Hotham Room	34	7.1	4.8	9	12	12	24	20	16
Latrobe Room	96	9.8	9.8	18	27	18	50	40	50
Boardroom 1	27	4.7	5.7			8			
Boardroom 2	30	4	7.4			12			
Stradbroke Foyer	490								120
Full Foyer									800
Jolimont Room				15	20	18	40	40	30
Jolimont Foyer				30	40	36	100	100	100
Cliveden Dining								200	
Cliveden Bar								24 (long table)	80
Cliveden Dining Existing Setup								200	
Cliveden Dining Semi Private								60	
ROOM COMBINATIONS									
Ballroom 1 & 2		24.8	15.4		204		400	250	350
Ballroom 2 & 3	515	24.8	20.8		297		600	320	500
Grand Ballroom 1, 2 & 3	707	24.8	28.5		400		850	510	1000
Hotham/Hopetoun	89	7.1	12.6		36	15	59	50	50
Stradbroke/Huntingfield	162	11.1	14.6		90		160	120	120
Huntingfield/Delacombe	185	11.1	16.7		90		180	140	160
Stradbroke/Huntingfield/Delacombe	277	11.1	25		135		240	200	150



pullman
HOTELS AND RESORTS

ACCESS TO THE HOTEL

192 Wellington Parade, East Melbourne VIC 3002 Australia
T: +61 (3) 9419 2000 F: +61 (3) 9419 2001 E: h9875@accor.com

By plane: 25km from Domestic and International Airports
By public transport: Jolimont Train Station 190m. Tram stop at hotel doorstep



/pullmanonthepark



@pullmanonthepark

pullmanhotels.com
pullmanonthepark.com.au